



Shoalhaven
City Council

LAKE TABOURIE BUSHCARE ACTION PLAN

CONTACT INFORMATION

Group Name:	Lake Tabourie Bushcare Group
Contact:	Kaye Milsom
Address:	10 South Street, LAKE TABOURIE, NSW, 2539
Phone:	4457 3406
Email:	
Reserve Name:	River Road Reserve
Reserve Number:	SLT862 and SLT917 / SLT861 Dermal Road Reserve, 862, 864 River Road Reserve, 866, 867 Prices Highway Reserve, 868, 917
Land Tenure:	Crown Trust Managed and Council
Comm. Land Type:	Natural Area and Park

1. BUSHCARE GROUP GOALS

Aim: Enhance environmental quality of Lake Tabourie through the maintenance and rehabilitation of natural areas
Objectives: Reduce foreshore erosion Improve community beach access facilities along boardwalk Increase community awareness of Bushcare activities and participation in Bushcare Group Reduce weed infestations. Provide for usable community bushland and improve biodiversity Maintain works undertaken under Grant funding

2. SHOALHAVEN BUSHCARE GROUP ACTION PLAN - To be in conjunction with attached site map.

NOTE: priority should be rated as H = High (within 12 months); M = Medium (1-3 years); L = Low

GROUP ACTION (these should relate to your project description)	PRIORITY	METHOD	TIME
Site 1 / Princes Highway Reserve Bridge installation works are planned in this area. Upon completion of this project which will include site rehabilitation (weed removal and planting), the assistance from the Bushcare Group	L	Work with Council works and services section to organise for Bushcare Group to assist with revegetation component	In conjunction with bridge works 2010
Site 2 / Oak Avenue and Short Street Asparagus Fern Scottish Broom Kikuyu Paspalum Cassia Garden Escapes	H	Spot spray and hand removal	Ongoing
Site 3 / River Road Reserve - Existing Rehab Area Manage population of <i>Pittosporum undulatum</i> to maintain biodiversity Target exotic grasses at River Road Proposed River Road Landscape Plan Assist council with implementing the River Rd Landscape Plan by: <ul style="list-style-type: none"> • Planting of understory species as per plan in vegetation islands • Weed removal • Spreading mulch and on- going maintenance of the vegetation islands 	H	Spot spray annuals using glyphosate at rate of 1:100	Ongoing 2010/11

<p>Site 4 / Short and Beach Streets Asparagus fern Cassia Manage populations <i>Pittosporum undulatum</i> to maintain biodiversity Remove small ones by hand Under prune lower growth to lift to avoid damage to walkers eyes</p>	M	Spot spray, cut and paint and hand removal	Ongoing
<p>Site 5 / Foreshore and Dunes Turkey rhubarb Asparagus Morning glory Cobblers pegs Maintenance of tubestock</p>	H	Spot spray or hand removal	
<p>Site 6 / Foreshore Area Maintenance Kikuyu which will require poison Weed removal Seed collection of dunes with Milton Landcare Target dunes - stressing weeds</p>	M	Turkey Rhubarb Tubes Poisoning needle or paint and scrape Kikuyu and Asparagus fern require two different sprays	Ongoing
<p>Site 7 Eastern side of Lemon Tree Creek Target weeding of Asparagus fern, Honeysuckle, Agapanthus and Formosan Lily Management of <i>Pittosporum undulatum</i> species in the bushland remnant to maintain biodiversity.</p>	H L	Hand removal and bag all propagules Council prepare REF for Pittosporum removal	2010 on-going

3. BUSHCARE GROUP ACTION PLAN MAP & RIVER ROAD LANDSCAPE PLAN

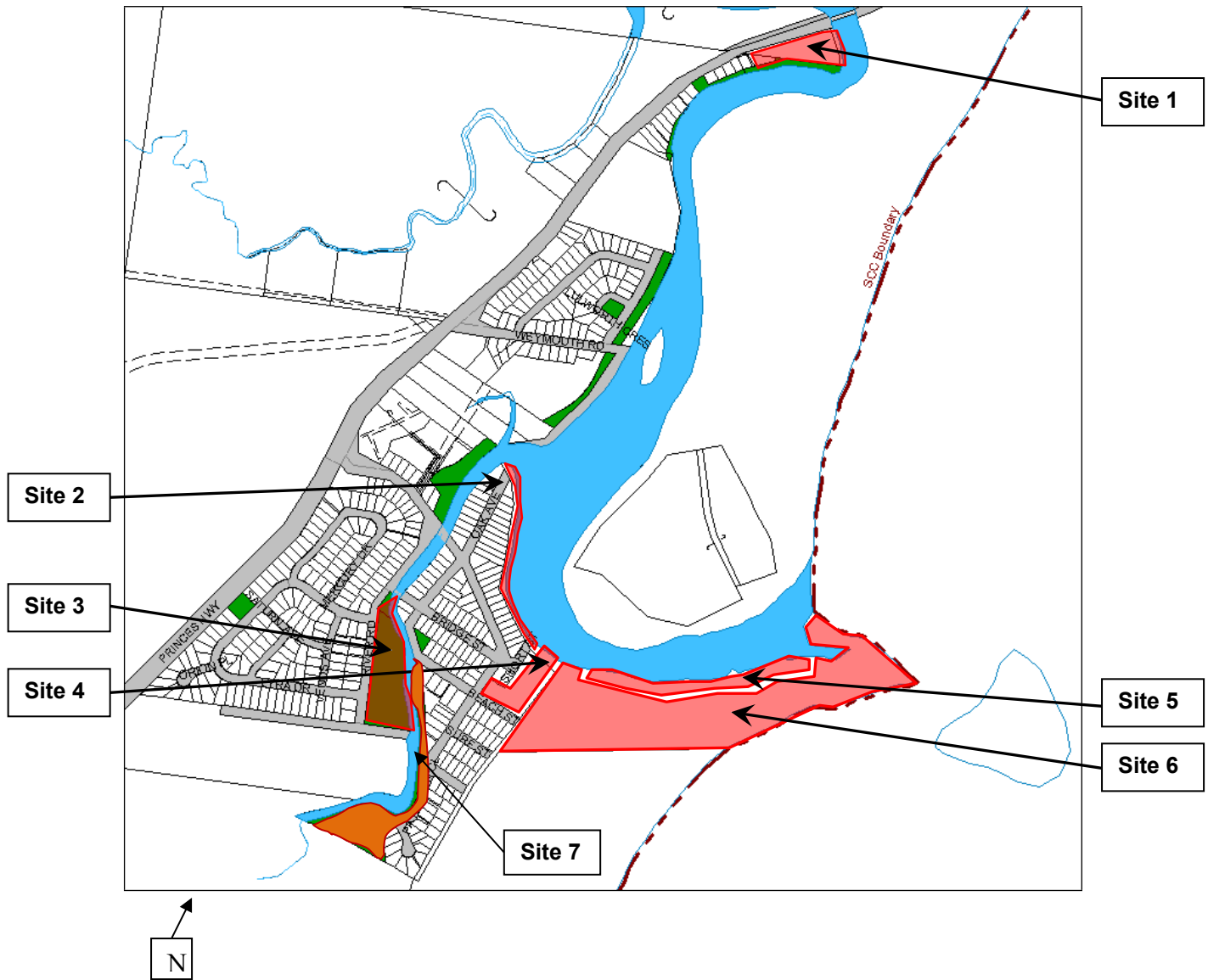

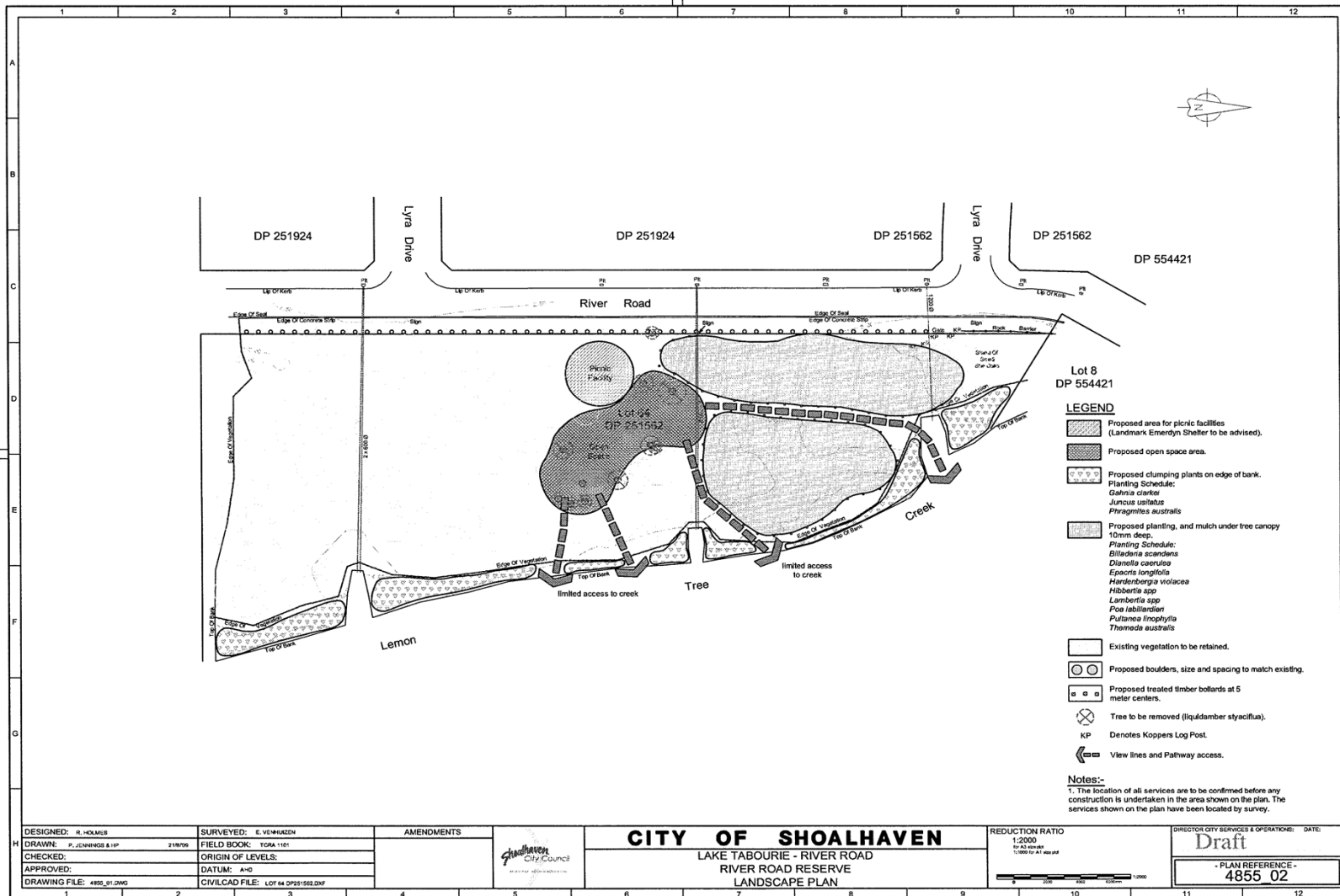

4. BUSHCARE GROUP OH&S AND EQUIPMENT REQUIREMENTS

TYPE OF ACTIVITY	SWMS NAME INCLUDED
Manual weed control (cut & paint, scrape & paint etc.)	Manual weed control Noxious weeds vegetation control
Chemical control (spraying of herbicides)	Weed control using backpack and smaller units Handling poisons
Planting	Tree removal and planting
Minor construction (walking track, fencing, outdoor furniture)	Landscaped area maintenance
Propagation & seed collection	Planting and seed collection
Education (school groups, field days etc.)	As appropriate
Other	Mowing using a tractor, ride-on or push mower

5. COUNCIL SUPPORT

- a. Provision Tools, Equipment, PPE and Chemical
- b. Provision of Bushcare Support Workers for 6 sessions over 12 months
- c. Assistance with all aspects of walking track maintenance as well as other Council assets on the reserve
- d. Provision of mulch and plants within budget capacity
- e. Free green waste tipping fees of up to \$24 per month Assistance with technical advice
- f. Removal of larger debris – Council employ staff to help in the removal of this debris
- g. Removal of rubbish – debris build up and rubbish collection will be stacked by Bushcare Group and designated aid workers, to be left at a convenient place for Council pickup.
- h. Carrying heavier objects – employ aid staff to help in areas, such as those where debris removal is required, to remove heavier objects from these areas (need identified by Bushcare Group)
- i. River Road Landscape Plan – Supply and installation of bollards/rock, plants, mulch and plant equipment.
- j. Seek budget bid to install picnic shelter or picnic table.

6. HAS A SITE HAZARD AND RISK ASSESSMENT BEEN COMPLETED FOR THE BUSHCARE SITE?

No

Attach a copy of the site/s risk assessment to the plan

7. LIST THE PERSONAL PROTECTION EQUIPMENT (PPE) REQUIRED FOR VOLUNTEERS WHILST WORKING ON THE SITE

PPE EQUIPMENT REQUIRED
First Aid Kit
Gloves
Sunscreen
Insect repellent

8. POSSIBLE FUTURE FUNDING

PROJECT	FUNDING SOURCE
Installation of seating along dune/open parkland area	Environmental Trust – Grant application

9. PLAN WILL BE REVIEWED EVERY THREE YEARS – NEXT REVIEW DUE:

APRIL 2013

Note: The group should review a summary of the Bushcare Policy & Procedures at the time of each annual review

10. LIST OTHER LOCAL/REGIONAL MANAGEMENT PLANS OR STRATEGIES THAT THIS PLAN RELATES TO:

DOCUMENT NAME	YEAR PRODUCED	PRODUCED BY
Tabourie Lake Entrance Management Policy and Review of Environmental Factors	2005	Shoalhaven City Council
Draft Shoalhaven Coastal Management Plan		Shoalhaven City Council
Tabourie Estuary Management Plan	1997	Shoalhaven City Council
Generic Community Land – Natural Areas Plan of Management	2002	Shoalhaven City Council
Shoalhaven Foreshore Reserve Policy	2005	Shoalhaven City Council

11. SUGGESTED SPECIES LIST FOR FUTURE SITE REVEGETATION

OVERSTOREY TREES	
Botanical	Common
<i>Acmena smithii</i>	Lilly Pilly
<i>Banksia integrifolia</i>	Coastal Banksia
<i>Banksia serrata</i>	Old Man Banksia
<i>Casuarina glauca</i>	She Oak / Swamp Oak
<i>Eucalyptus botryoides</i>	Bangalay
SHRUBS	
Botanical	Common
<i>Acacia longifolia</i>	Sydney Golden Wattle
<i>Acacia longifolia</i> spp <i>sophorae</i>	Coastal Wattle
<i>Allocasuarina littoralis</i>	Black Sheoak
<i>Breynia oblongifolia</i>	Dwarf's Apple / Coffee Bush
<i>Leptospermum laevigatum</i>	Coastal Tea Tree
<i>Monotoca elliptica</i>	Tree Broom Heath
<i>Notelaea longifolia</i>	Large Leaved / Mock Olive
<i>Pittosporum revolutum</i>	Rough Fruited Pittosporum
UNDERSTOREY (grasses, herbs, climbers)	
Botanical	Common
<i>Billardiera scandens</i>	Apple Dumpling Vine
<i>Carex longibrachiata</i>	Drooping Sedge
<i>Commelina cyanea</i>	Native Wandering Jew
<i>Dianella caerulea</i> var. <i>caerulea</i>	Native Blue Flax Lily
<i>Hardenbergia violacea</i>	Wandering Postman
<i>Hibbertia scandens</i>	Golden Guinea Flower
<i>Kennedia rubicunda</i>	Dusty Coral Pea
<i>Lomandra longifolia</i>	Spiky Headed Matt Rush
<i>Microlaena stipoides</i> var. <i>stipoides</i>	Weeping Grass
<i>Themeda australis</i>	Kangaroo Grass
<i>Viola hederacea</i>	Native Violet

12. SITE WEED LIST

Noxious	Other	Control Method
	<i>Acetosa sagittata</i> (Turkey Rhubarb)	Spot spray with glyphosate at ratio of 1:100 during spring – summer period, bag all seeds.
	<i>Asparagus densifomas</i> (Basket asparagus)	Crown out the rhizome and remove from site
	<i>Erythrina x sykesii</i> (Coral Tree)	Large trees need to be drilled and injected with neat glyphosate smaller regrowth can be treated using the cut stump method
	<i>Juncus acutus</i> (Spiny Rush)	Cut of all seed heads and bag and dispose off. Then spray plants with glyphosate at a ratio of 1:75 with a wetting agent added ensure the entire plant is covered, young plants can be hand pulled.
	<i>Stenotaphrum secundatum</i> (Buffalo grass)	Spot spray with glyphosate in Winter at ratio of 1:100